

# PUNCHING AND SEALING MACHINE FOR LAB-BASED FEASIBILITY STUDIES



The Rychiger RD 06 is designed to perform feasibility studies and test production runs with process parameters that are identical with those of industrial sealing machines, providing reproducible results. The processes can be transferred easily and with precise accuracy from the lab to the industrial machine. The adjustable touch panel allows the operator to adjust and monitor the process parameters as required.

#### Basic design

- Stand-alone unit, allowing for separation of base and top part for tabletop installation
- Compact machine frame, ergonomically optimised for manual operation
- Modular function layout, extendible with various standard elements
- Complete powder-coated machine cover made in aluminium
- Clean-room design conforming to ISO classes 7 and 8
- Hygienic design for fast and easy cleaning

#### Punching and sealing

- Adjustable sealing parameters (force, time and temperature) allow for the empirical determination and testing of the sealing process window
- Continuous operation of process parameters by means of force and temperature sensors
- Sealing and punching stroke and heating from top or bottom
- Servo-operated toggle lever, allowing for any chosen sealing and punching stroke profiles
- Punching assembly with dual guide along rear of machine for high-precision punching
- Optimized foil reeling and foil feeding unit for manual or automatic operation attached to the side of the base frame

#### Feed system

- Manual infeed of workpiece carrier
- Available with optional pneumatic lateral infeed unit that can be loaded automatically

#### Operation

- Ergonomically optimised working height for manual operation (1100 - 1200mm)
- Two-hand release mechanism through touch buttons for safe operation
- Colour touch screen serving as HMI for the display of monitored process parameters and the control of all machine functions

#### Control and safety

- Allen Bradley control and motion system
- Special servo drive model with „save direction“ function guarantees reliable and safe movement within operator range
- Process data storage and analyses on industrial PC equipped with all conventional interfaces for data export
- Machine conforming to CE standard

#### Documentation

- Supplied with comprehensive operating instructions
- Qualification documentation (DQ, IQ, OQ) available on request

# TECHNICAL DATA OF RD 06

Sealing time	Sealing temperature	Sealing force	Dimensions [lxwxh]	Weight	Format	Drive
0.1 - 180s	- 350°C	500 - 6000N	500x740x1850mm	approx. 300kg	up to Ø120mm	Servo

## MACHINE CONNECTIONS

Connected loads	Operating power	Cooling water	Compressed air
3 x 460 V + PE / 60 Hz 3 x 400 V + PE / 50 Hz	approx. 2kW	4-6 bar approx. 2l/min 15-20°C	4-6 bar approx. 10l/min

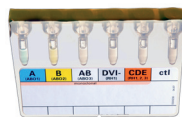
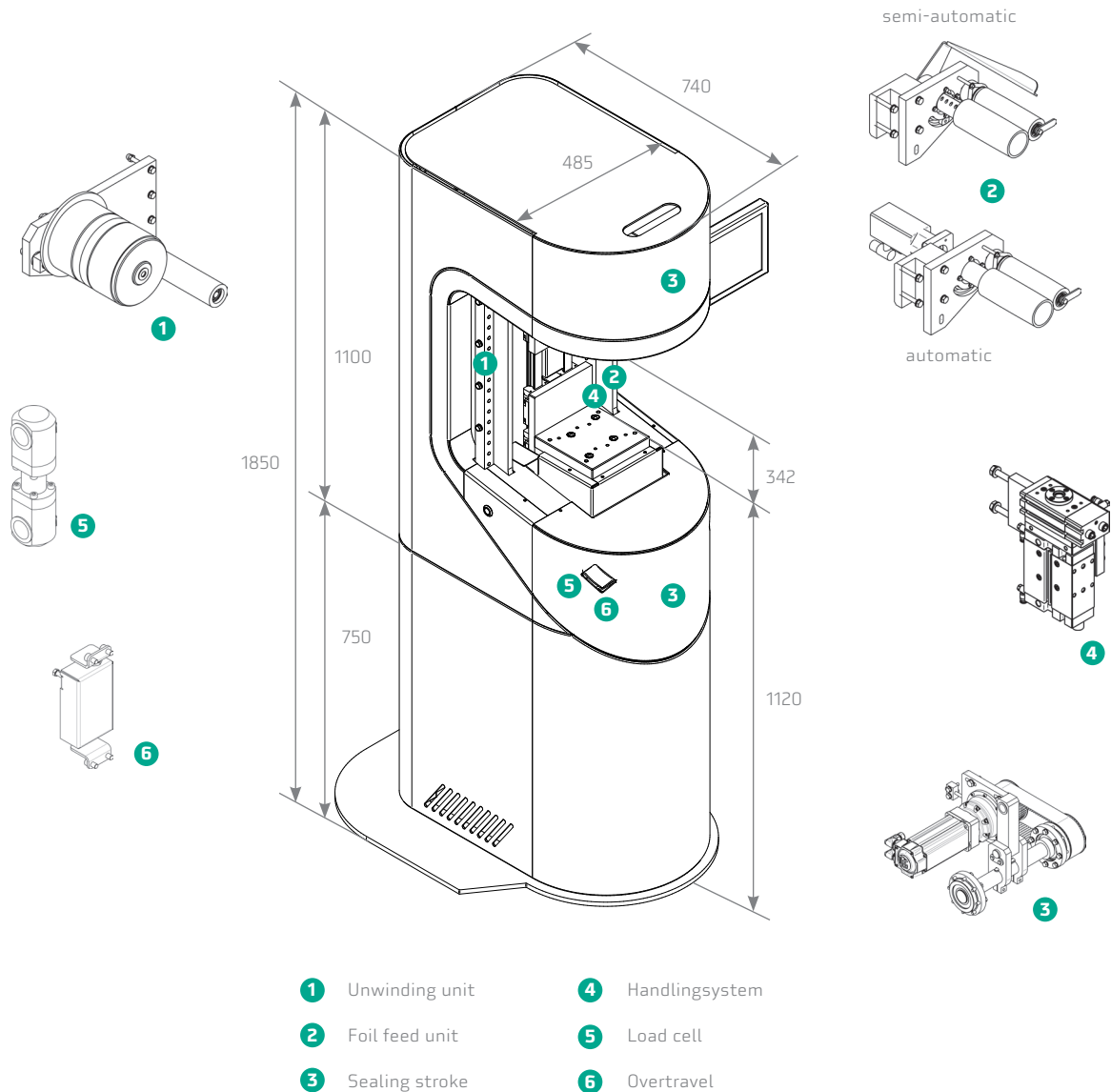

**Rychiger AG**  
 Alte Bernstrasse 135  
 3613 Steffisburg  
 Switzerland  
[www.rychiger.com](http://www.rychiger.com)

T +41 (0)33 439 68 68  
 F +41 (0)33 439 68 88  
[rychiger@rychiger.com](mailto:rychiger@rychiger.com)

**Rychiger US Inc.**  
 600 Spring Hill Ring Road  
 West Dundee, IL 60118  
 USA

T +1 (0)847 836 0612  
 F +1 (0)847 628 0708  
[us.service@rychiger.com](mailto:us.service@rychiger.com)